

mDD Explosion-proof LED signal beacon

- Certified for gas and dust hazardous areas of zone 1, 2, 21, 22
- Encapsulation "m"
- Polycarbonate plastic housing
- mounting bracket V4A

- 5 LED colours
- Degree of protection IP 66
- Protection class II (AC) or III (DC)
- Terminal connection chamber "increased safety e"

II 2 G Ex e mb (ib) IIC T4

II 2 D Ex mbD tD A21 IP 66 T130 °C

-40 °C ≤ Ta ≤ +60 °C (AC-Mod.)

-40 °C ≤ Ta ≤ +65 °C (DC-Mod.)

Zone 1, 2, 21, 22



TECHNICAL DATA

Housing	Ø 103 mm, Polycarbonate black (RAL 9005)
Lens	Polycarbonate, clear
Type of mounting	Bracket for wall mounting, V4A, any
Cable entry	Cable gland M20 × 1.5, 2× blind plugs M20 × 1.5
Connection technology	bis 2,5 mm ²
Beacon type	LED steady beacon, LED flashing beacon, LED strobe beacon or LED all-round light
Light source	LEDs
Luminous intensity	14 Cd (rot)
Duty cycle	100 %
Operating temperature	-40 °C / +60 °C
Degree of protection	IP66
Weight	2,5 kg

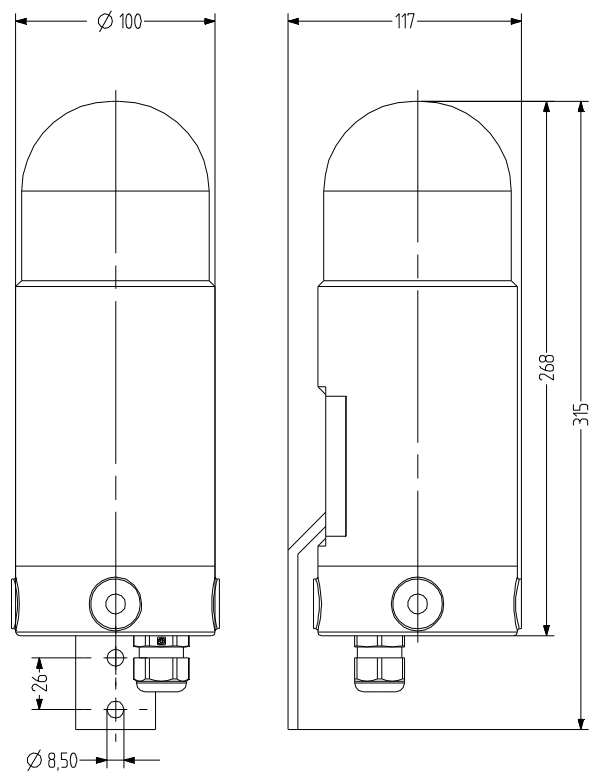

mDD

ORDER DATA

Type	Lens colour	Colour	Nominal voltage	Voltage range (V)	Nominal current (A)	Order number
mDD1	clear	red	230 V AC	+/- 20 %	0,035-0,047	336 002 413
		white	230 V AC	+/- 20 %	0,037-0,055	336 004 413
		blue	230 V AC	+/- 20 %	37-55	336 005 413
		green	230 V AC	+/- 20 %	0,037-0,055	336 006 413
		yellow	230 V AC	+/- 20 %	0,035-0,047	336 007 413
mDD2	clear	red	24 V DC	+/- 20 %	0,24-0,85	336 002 005
		white	24 V DC	+/- 20 %	0,32-1,28	336 004 005
		blue	24 V DC	+/- 20 %	0,31-1,25	336 005 005
		green	24 V DC	+/- 20 %	0,31-1,2	336 006 005
		yellow	24 V DC	+/- 20 %	0,24-0,9	336 007 005

